

## ELECTROMAGNETIC LOCKS

### MAGNALOCK SERIES

- SECURITY TECHNOLOGY FOR THE 21<sup>ST</sup> CENTURY
- HOLDING POWER FROM 600 TO 1,800 POUNDS
- MODELS FOR SURFACE, SHEAR AND RECESSED MOUNTING
- MAGNACARE LIFETIME REPLACEMENT WARRANTY

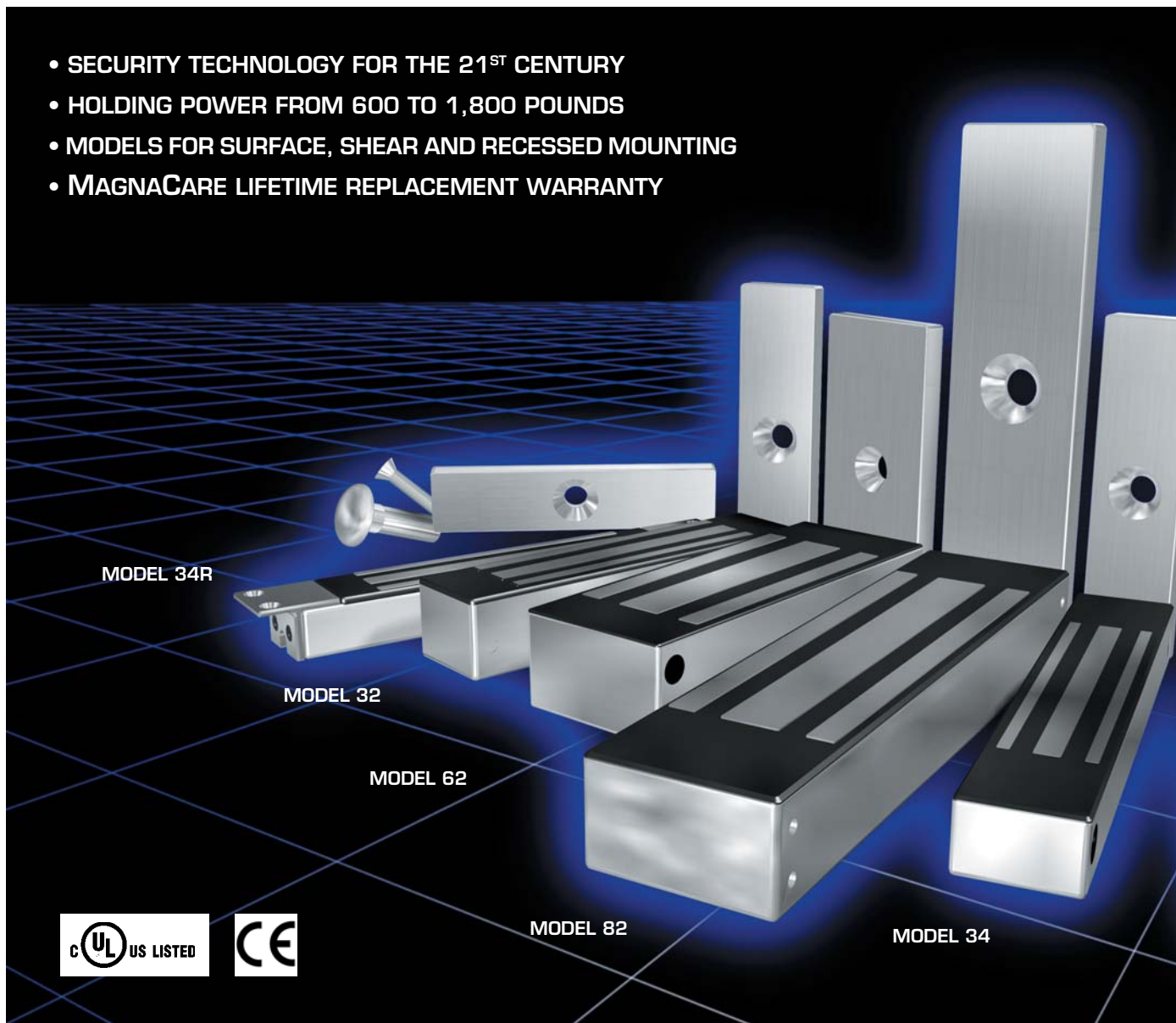

#### SECURITRON

Securitron has been making electromagnetic locks since 1971, and remains the industry leader through innovation and superior engineering. Security industry trade journals, installing dealers and end users consistently choose Magnalock as their most highly preferred product. Great features and proven performance in demanding applications are the reasons why.

#### MAGNALOCK TECHNOLOGY

Magnalocks are designed to secure any kind of door or gate that closes against a fixed stop. The product consists of an electromagnet which mounts on the fixed frame, and a strike plate which mounts on the moving door or gate. The strike plate is delivered with fasteners that let it flex, so when a door closes, it automatically self-aligns with the magnet. Powerful magnetic force then secures the door, and release is achieved by switching off current.

Magnalocks are remarkably efficient. Model 32 draws only 3-1/2 watts. Model 62 draws only 3 watts. Models 34 and 82SC draw only 4 watts. Low power consumption is especially important when large numbers of Magnalocks are operated from a central power supply. Efficiency saves in wire gauge, power supply and battery backup costs.

Advanced internal electronics eliminate problems found in other designs. Magnalocks reverse out residual magnetism and accelerate field collapse, so that inductive kickback and EMI are suppressed. There is no arcing over control switches, or interference with nearby electronics. Ferrous metal aging—which can lead to stickiness—is blocked. A U.S. patent has been granted on the Magnalock's internal electronics.

# ELECTROMAGNETIC LOCKS

## MAGNALOCK SERIES



**MODEL 32**

### MODEL 32 APPLICATIONS

Model 32 provides 600 pounds “traffic control” security—similar to electric strikes—and is recommended for applications where physical assault on the door is not expected, like access controlled interior rooms and secure areas within buildings. Primary benefits of this model are its lower cost and more compact size. Please specify voltage in 12 or 24 VDC when ordering

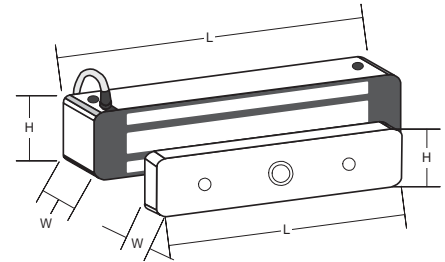

### PRODUCT FEATURES

- Instant release circuit—no residual magnetism
- Surface mounts easily with a minimum of tools
- Fully sealed electronics—tamper proof & weather proof
- Mounted using steel machine screws into blind finishing nuts
- Architectural brushed stainless steel finish (US32D/630)
- All ferrous metal surfaces plated to MIL specification
- Hardware accessories available to configure any opening type include mounting brackets, housings and dress covers
- Ten feet [3.05m] of jacketed, stranded conductor
- **UL Listed**

### HOLDING FORCE

600 lbs. [273 Kg.]

### CURRENT DRAW and VOLTAGE

300 mA at 12 VDC; or 150 mA at 24 VDC

### MODEL 32 DIMENSIONS

Magnet: 8" x 1 7/8" x 1 1/2" [203mm x 48mm x 38 mm]

Strike: 6 1/4" x 1 5/8" x 1/2" [159mm x 41mm x 13mm]

HOW TO ORDER	
PART#	DESCRIPTION
M32-12	Magnalock Model 32 12VDC
M32-24	Magnalock Model 32 24VDC



**MODEL 34**

### MODEL 34 APPLICATIONS

Model 34 offers 600 pounds holding force with the added convenience of automatic dual voltage. It is also recommended for applications where physical assault on the door is not expected, or for interior access control and security. Version 34R permits recessed mounting in sliding doors, and results in an aesthetically appealing finished appearance.

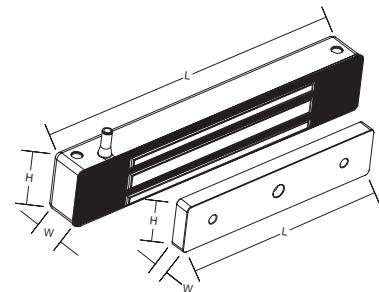

### PRODUCT FEATURES

- Instant release circuit—no residual magnetism
- Surface mounts easily with a minimum of tools
- Fully sealed electronics—tamper proof & weather proof
- Mounted using steel machine screws into blind finishing nuts
- Architectural brushed stainless steel finish (US32D/630)
- All ferrous metal surfaces plated to MIL specification
- Hardware accessories available to configure any opening type include mounting brackets, housings and dress covers
- Ten feet [3.05m] of jacketed, stranded conductor
- Automatic dual voltage—no field adjustment required
- **UL Listed**

### HOLDING FORCE

600 lbs. [273 Kg.]

### CURRENT DRAW and VOLTAGE

350 mA at 12 VDC; or 175 mA at 24 VDC

### DIMENSIONS

34 Magnet: 9 3/4" x 1 3/4" x 1 1/8" [248mm x 44mm x 29mm]

34R Magnet: 10 9/16" x 1 1/2" x 1 1/8" [264mm x 38mm x 29mm]

34 & 34R Strike: 6 3/8" x 1 7/16" x 7/16" [162mm x 36mm x 11mm]

HOW TO ORDER	
PART#	DESCRIPTION
M34	Magnalock Model 34
M34R	Magnalock Model 34 Recessed

## ELECTROMAGNETIC LOCKS

### MAGNALOCK SERIES



#### MODEL 62 APPLICATIONS

Model 62 increases holding power to 1,200 pounds, appropriate for exterior and perimeter doors through which criminals could gain entrance to cause substantial economic loss. Entry cannot be forced without special tools, or before the door and frame actually give way. Model 62 is also available with the "G" option, which adds a universal conduit fitting for outdoor installations or surface-wired installations on concrete filled door frames.

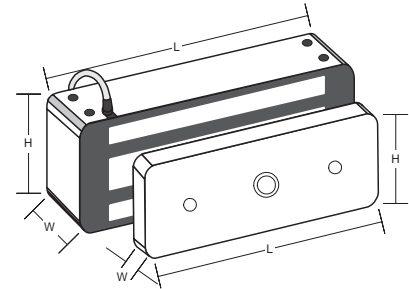

#### PRODUCT FEATURES

- Instant release circuit—no residual magnetism
- Surface mounts easily with a minimum of tools
- Fully sealed electronics—tamper proof & weather proof
- Mounted using steel machine screws into blind finishing nuts
- Architectural brushed stainless steel finish (US32D/630)
- All ferrous metal surfaces plated to MIL specification
- Hardware accessories available to configure any opening type include mounting brackets, housings and dress covers
- Ten feet [3.05m] of jacketed, stranded conductor
- Automatic dual voltage—no field adjustment required
- **UL Listed**

#### HOLDING FORCE

1,200 lbs. [546 Kg.]

#### CURRENT DRAW and VOLTAGE

250 mA at 12 VDC; or 125 mA at 24 VDC

#### DIMENSIONS

Magnet: 8" x 3" x 1 3/4" [203mm x 76mm x 44mm]

Strike: 6" x 2 3/4" x 1/2" [152mm x 70mm x 13mm]

#### HOW TO ORDER

PART#	DESCRIPTION
M62	Magnalock Model 62



#### MODEL 82SC APPLICATIONS

Model 82SC is the largest and most powerful Magnalock, delivering 1,800 pounds holding force to stop determined intruders who will often employ special tools in their effort to gain entry. Model 82SC is preferred by prisons and detention facilities, and also functions best on large, high security gates.

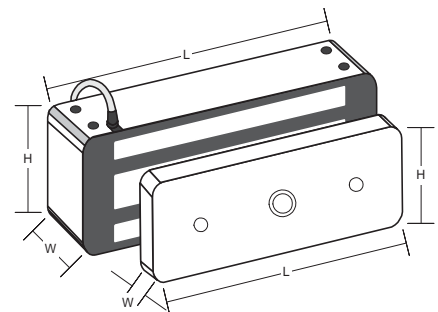

#### PRODUCT FEATURES

- Instant release circuit—no residual magnetism
- Surface mounts easily with a minimum of tools
- Fully sealed electronics—tamper proof & weather proof
- Mounted using steel machine screws into blind finishing nuts
- Architectural brushed stainless steel finish (US32D/630)
- All ferrous metal surfaces plated to MIL specification
- Hardware accessories available to configure any opening type include mounting brackets, housings and dress covers
- Ten feet [3.05m] of jacketed, stranded conductor
- Automatic dual voltage—no field adjustment required
- **UL Listed**

#### HOLDING FORCE

1,800 lbs. [818 Kg.]

#### CURRENT DRAW and VOLTAGE

350 mA at 12 VDC; or 175 mA at 24 VDC

#### DIMENSIONS

Magnet: 12" x 3" x 1 3/4" [305mm x 76mm x 44mm]

Strike: 9 1/2" x 2 3/4" x 1/2" [241mm x 70mm x 13mm]

#### HOW TO ORDER

PART#	DESCRIPTION
M82SC	Magnalock Model 82 Senstat

## ELECTROMAGNETIC LOCKS

### MAGNALOCK SERIES STANDARD MODELS

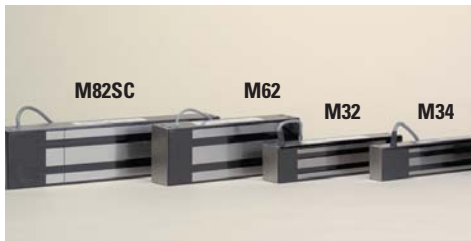

ITEM	PART#	ORDERING DESCRIPTION
<b>MAGNALOCK MODEL 32</b> PLEASE SPECIFY 12 OR 24 VOLT MODEL	<b>M32-12</b> <b>M32-24</b>	600 lb. 12VDC Magnalock 600 lb. 24VDC Magnalock
<b>MAGNALOCK MODEL 34</b> ALL M34 MAGNALOCKS ARE DUAL VOLTAGE	<b>M34</b>	600 lb. Dual Voltage Magnalock
<b>MAGNALOCK MODEL 62</b> ALL M62 MAGNALOCKS ARE DUAL VOLTAGE	<b>M62</b>	1200 lb. Dual Voltage Magnalock
<b>MAGNALOCK MODEL 82SC</b> AVAILABLE ONLY WITH SENSTAT OPTION ALL M82 MAGNALOCKS ARE DUAL VOLTAGE	<b>M82SC</b>	1800 lb. Dual Voltage Senstat Magnalock

## ELECTROMAGNETIC LOCKS

### MAGNALOCK SERIES OPTIONS

ITEM	APPLICATION USE	PART#	ORDERING DESCRIPTION
<p><b>SENSTAT: A SELF-MONITORING MAGNALOCK</b></p> <p>WHITE AND GREEN WIRES PROVIDE ISOLATED CLOSURE WHEN LOCK IS SECURE. ORANGE AND WHITE ARE CLOSED WHEN LOCK IS NOT SECURE.</p> <p><i>Wiring diagram for Senstat Magnalocks.</i></p>	<p>The lock that monitors itself! Securitron's patented Senstat option provides a lock status sensing signal which positively indicates that the door is secure. This interfaces with access control or alarm systems and is superior to the commonly used door position switch which indicates that the door is closed but not that it is secure.</p> <p>All Senstat Magnalocks use Form 'C' isolated contacts.</p>	<b>M32SC-12</b> Model 32 Senstat 12 VDC <b>M32SC-24</b> Model 32 Senstat 24 VDC <b>M32SCF-12</b> Model 32 Senstat Face Mount 12 VDC <b>M32SCF-24</b> Model 32 Senstat Face Mount 24 VDC	
		<b>M34RSC</b> Model 34 Recessed Senstat <b>M34SC</b> Model 34 Senstat <b>M34SCF</b> Model 34 Senstat Face Mount	
		<b>M62SC</b> Model 62 Senstat <b>M62SCF</b> Model 62 Senstat Face Mount <b>M62SCFG</b> Model 62 Senstat Face Mount Conduit <b>M62SCG</b> Model 62 Senstat Conduit <b>M62SCG-OS</b> Model 62 Senstat Conduit/Offset Strike <b>M62SCG-SS</b> Model 62 Senstat Conduit/Split Strike <b>M62SC-OS</b> Model 62 Senstat Offset Strike <b>M62SC-SS</b> Model 62 Senstat Split Strike <b>DM62SC</b> Model 62 Double Senstat	
		<b>M82SC</b> Model 82 Senstat <b>M82SCF</b> Model 82 Senstat Face Mount <b>M82SCFG</b> Model 82 Senstat Face Mount Conduit <b>M82SCG</b> Model 82 Senstat Conduit <b>M82SCG-OS</b> Model 82 Senstat Conduit/Offset Strike <b>M82SCG-SS</b> Model 82 Senstat Conduit/Split Strike <b>M82SC-OS</b> Model 82 Senstat Offset Strike <b>M82SC-SS</b> Model 82 Senstat Split Strike	

### THE "F" OPTION— FACE MOUNTED MAGNALOCKS



Standard Magnalocks are suspended from the door frame, so the door swings away from the magnet body—the preferred mounting method. But if the door swings into the protected area security considerations may dictate the lock mounts on the in-swinging side of the door. The "F" option provides for face mounting on the header above the door. Mounting holes are drilled through the magnet face, and wire exits the rear.

The Z bracket is normally used with "F" Magnalocks.

(Model 34F not pictured.)

<b>M32F-12</b> <b>M32F-24</b> <b>M32SCF-12</b> <b>M32SCF-24</b>	Model 32 Face Mount 12VDC Model 32 Face Mount 24VDC Model 32 Senstat Face Mount 12VDC Model 32 Senstat Face Mount 24VDC
<b>M34F</b> <b>M34SCF</b>	Model 34 Face Mount Model 34 Senstat Face Mount
<b>M62F</b> <b>M62FG</b> <b>M62SCF</b> <b>M62SCFG</b>	Model 62 Face Mount Model 62 Face Mount Conduit Model 62 Senstat Face Mount Model 62 Senstat Face Mount Conduit
<b>M82SCF</b> <b>M82SCFG</b>	Model 82 Senstat Face Mount Model 82 Senstat Face Mount Conduit

# ELECTROMAGNETIC LOCKS

## MAGNALOCK SERIES OPTIONS



ITEM	APPLICATION USE	PART#	ORDERING DESCRIPTION
<p><b>THE "G" OPTION—UNIVERSAL CONDUIT FITTED MAGNALOCKS</b></p>	<p>The "G" option (available on the 62 and 82 Models only) adds a 3/4" female—1" male universal conduit fitting to allow conduit wiring for outdoor installations. The "G" version is also useful for surface wired installations on concrete filled door frames. This avoids the cost of drilling a wire way in the concrete. (See image below.)</p>	<p><b>M62FG</b> Model 62 Face Mount Conduit  <b>M62G</b> Model 62 Conduit  <b>M62G-OS</b> Model 62 Conduit Offset Strike  <b>M62G-SS</b> Model 62 Conduit Split Strike  <b>M62SCFG</b> Model 62 Senstat Face Mount Conduit  <b>M62SCG</b> Model 62 Senstat Conduit  <b>M62SCG-OS</b> Model 62 Senstat Conduit Offset Strike  <b>M62SCG-SS</b> Model 62 Senstat Conduit Split Strike</p> <p><b>M82SCFG</b> Model 82 Senstat Face Mount Conduit  <b>M82SCG</b> Model 82 Senstat Conduit  <b>M82SCG-OS</b> Model 82 Senstat Conduit Offset Strike  <b>M82SCG-SS</b> Model 82 Senstat Conduit Split Strike</p>	
 <p><i>Model 62FG with Universal Conduit Fitting.</i></p> <p><i>Model 82SCFG with Universal Conduit Fitting.</i></p>			
<p><b>DOUBLE MODEL 62 CONFIGURATION</b></p>	<p>For double doors without a center mullion, the DM-62 supplies two 1,200 lb. holding force Model 62 Magnalocks in a single, brushed stainless steel housing. The 22" [572mm] wide housing provides adequate lock separation for internal obstructions often found in double doors. Electrically, the dual locks are controlled as one.</p>	<p><b>DM62</b> Model 62 Double Magnalock  <b>DM62SC</b> Model 62 Double Magnalock Senstat</p>	
			
<p><b>OFFSET STRIKES and SPLIT STRIKES</b></p>	<p>Offset strikes are available for the 62 and 82 models only. The offset strike alters by 1/4" [6mm] the position of the mounting hole which is occasionally necessary for certain narrow aluminum glass doors to avoid the sex bolt hitting the glass.</p> <p>Split strikes allow a single 62 or 82 model Magnalock to secure a double door at traffic control holding force level.</p>	<p><b>M62-OS</b> Model 62 Offset Strike  <b>M62G-OS</b> Model 62 Conduit Fitting Offset Strike  <b>M62SCG-OS</b> Model 62 Senstat Conduit Offset Strike  <b>M62SC-OS</b> Model 62 Senstat Offset Strike  <b>M62-SS</b> Model 62 Split Strike  <b>M62G-SS</b> Model 62 Conduit Fitting Split Strike  <b>M62SCG-SS</b> Model 62 Senstat Conduit Split Strike  <b>M62SC-SS</b> Model 62 Senstat Split Strike</p> <p><b>M82SCG-OS</b> Model 82 Senstat Conduit Offset Strike  <b>M82SC-OS</b> Model 82 Senstat Offset Strike  <b>M82SCG-SS</b> Model 82 Senstat Conduit Split Strike  <b>M82SC-SS</b> Model 82 Senstat Split Strike</p>	
			

*Model 82SCG mounted on a concrete filled steel door frame using the CWB-62 bracket.*





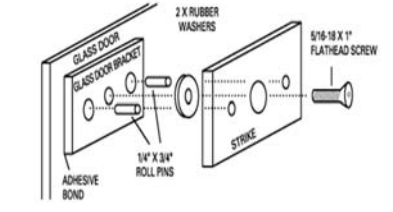

# ELECTROMAGNETIC LOCKS

## MAGNALOCK SERIES HARDWARE

ITEM	APPLICATION USE	PART#	ORDERING DESCRIPTION
<p><b>FULL LENGTH HOUSINGS</b></p>  <p><i>Single Horizontal Full Length Housing</i></p> <p><i>Double Vertical Full Length Housing</i></p>	<p>Magnalocks can be installed in full-length housings for the ultimate in security and finished appearance. Select housings in vertical or horizontal configurations, to fit one or two locks. The addition of a second lock is for extra security, or a double door. Finished installation provides solid vandal resistance.</p> <p>SLR = single lefthand reverse</p> <p>SRR = single righthand reverse</p>	<p><b>HHD-32</b>  <b>HHD-62</b>  <b>HHD-82</b>  <b>HHSL-32</b>  <b>HHSL-62</b>  <b>HHSL-82</b>  <b>HHSR-32</b>  <b>HHSR-62</b>  <b>HHSR-82</b>  <b>HVD-32</b>  <b>HVD-62</b>  <b>HVD-82</b></p>	<p>Full Length Housing M32 Dbl. Horizontal            Full Length Housing M62 Dbl. Horizontal            Full Length Housing M82 Dbl. Horizontal            Full Length Housing M32 SLR Horizontal            Full Length Housing M62 SLR Horizontal            Full Length Housing M82 SLR Horizontal            Full Length Housing M32 SRR Horizontal            Full Length Housing M62 SRR Horizontal            Full Length Housing M82 SRR Horizontal            Full Length Housing M32 Dbl. Vertical            Full Length Housing M62 Dbl. Vertical            Full Length Housing M82 Dbl. Vertical</p>
<p><b>ENERGY ABSORBING SEX BOLT</b></p> 	<p>The EASB is specifically designed for high security applications on inflexible doors, like those found in prisons where a door opens outward into a protected area. During an impact attack—unlike pulling the door—the impact force transmits well to the lock. The EASB replaces the standard sex bolt, and contains a powerful internal spring that absorbs and dissipates the force of a blow, maintaining optimum security.</p> <p>EASB-34: 2" [51mm] diameter crown            1 3/4" [44mm] length            1" [25mm] maximum travel</p> <p>EASB-62 &amp; 82: 3" [76mm] diameter crown            1 3/4" [44mm] length            1" [25mm] maximum travel</p>	<p><b>EASB-34</b>  <b>EASB-62</b>  <b>EASB-82</b></p>	<p>Sex Bolt Energy Absorbing M34            Sex Bolt Energy Absorbing M62            Sex Bolt Energy Absorbing M82</p>
<p><b>STOP FILLER PLATE</b></p> 	<p>The Stop Filler Plate is used in installations where only part of the magnet body is on the stop. The plate extends the stop to provide a flat mounting surface for the magnet. Stop Filler Plates are 8" [203mm] (Models 32 and 62) or 12" [305mm] (Model 82) with a varying thickness to match the stop thickness.</p> <p>Width = 1 1/4" [32mm]            Depth = 1/4" [6mm]            3/8" [10mm]            1/2" [13mm]            5/8" [16mm]</p>	<p><b>SFP-1/4CL</b>  <b>SFP-1/4BK</b>  <b>SFP-3/8CL</b>  <b>SFP-3/8BK</b>  <b>SFP-1/2CL</b>  <b>SFP-1/2BK</b>  <b>SFP-5/8CL</b>  <b>SFP-5/8BK</b>  <b>SFP82-1/4CL</b>  <b>SFP82-1/4BK</b>  <b>SFP82-3/8CL</b>  <b>SFP82-3/8BK</b>  <b>SFP82-1/2CL</b>  <b>SFP82-1/2BK</b>  <b>SFP82-5/8CL</b>  <b>SFP82-5/8BK</b></p>	<p>Stop Filler Plate 1/4" Clear            Stop Filler Plate 1/4" Black            Stop Filler Plate 3/8" Clear            Stop Filler Plate 3/8" Black            Stop Filler Plate 1/2" Clear            Stop Filler Plate 1/2" Black            Stop Filler Plate 5/8" Clear            Stop Filler Plate 5/8" Black            Stop Filler Plate M82 1/4" Clear            Stop Filler Plate M82 1/4" Black            Stop Filler Plate M82 3/8" Clear            Stop Filler Plate M82 3/8" Black            Stop Filler Plate M82 1/2" Clear            Stop Filler Plate M82 1/2" Black            Stop Filler Plate M82 5/8" Clear            Stop Filler Plate M82 5/8" Black</p>
<p><b>GLASS DOOR BRACKET ADHESIVE KIT and GLASS DOOR HEADER EXTENSION BRACKET</b></p> 	<p>The Glass Door Bracket permits Magnalock installation on a solid glass door. The bracket is permanently bonded to the glass with a special adhesive. The strike plate then screws into the bracket, as glass doors cannot be drilled.</p>	<p><b>GDB</b>  <b>AKG</b>  <b>HEB-3G</b></p>	<p>Glass Door Bracket            Adhesive Kit For Glass Hdw.            Header Ext. Bracket 3" x 3" x 8" Glass Door</p>
<p><b>ALUMINUM SPACER BRACKET</b></p> 	<p>The Aluminum Frame Spacer Bracket is for use with aluminum frame glass doors. The bracket spaces the magnet body down 1/2" [13mm] to clear the blade stop and provides alternate mounting hardware for the strike plate. With the magnet body spaced down, the standard sex bolt may interfere with the glass.</p>	<p><b>ASB-32CL</b>  <b>ASB-32BK</b>  <b>ASB-62CL</b>  <b>ASB-62BK</b>  <b>ASB-82CL</b>  <b>ASB-82BK</b></p>	<p>Aluminum Spacer Bracket M32 Clear            Aluminum Spacer Bracket M32 Black            Aluminum Spacer Bracket M62 Clear            Aluminum Spacer Bracket M62 Black            Aluminum Spacer Bracket M82 Clear            Aluminum Spacer Bracket M82 Black</p>

# ELECTROMAGNETIC LOCKS

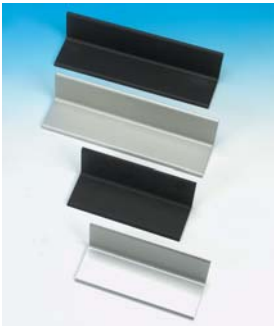
## MAGNALOCK SERIES HARDWARE

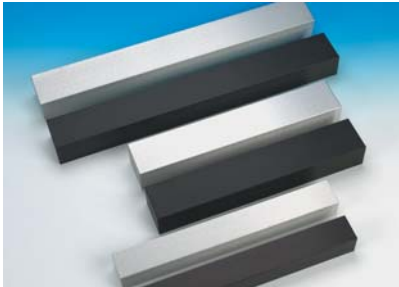
ITEM	APPLICATION USE	PART#	ORDERING DESCRIPTION
<b>CONCRETE/WOOD BRACKET</b> 	<p>The Concrete/Wood Frame Bracket is used on concrete filled or wood door frames. On concrete filled frames the bracket anchors to the frame using sheet metal screws; the magnet mounts to the bracket with machine screws. The bracket includes a central splice area, avoiding the need to drill a wireway through the concrete. On wood frames, 4" [104mm] wood screws penetrate into the header. Separate part numbers are used for the Model 32, 62, and 82 Magnalocks.</p>	<b>CWB-32CL</b> <b>CWB-32BK</b> <b>CWB-62CL</b> <b>CWB-62BK</b> <b>CWB-82CL</b> <b>CWB-82BK</b>	<b>Concrete/Wood Bracket M32 Clear</b> <b>Concrete/Wood Bracket M32 Black</b> <b>Concrete/Wood Bracket M62 Clear</b> <b>Concrete/Wood Bracket M62 Black</b> <b>Concrete/Wood Bracket M82 Clear</b> <b>Concrete/Wood Bracket M82 Black</b>
<b>UNIVERSAL HEADER BRACKET</b> 	<p>The Universal Header Bracket is used to extend a narrow header (often found on aluminum frame glass doors) to permit mounting of the Magnalock. The bracket is positioned either to extend 1" [26mm] or 1-1/2" [38mm], and also serves to conceal the hookup cable within its hollow interior. Model UHB works with Model 32, 34 or 62 series Magnalocks and the longer UHB-82 works with the Model 82.</p>	<b>UHB-CL</b> <b>UHB-BK</b> <b>UHB-82CL</b> <b>UHB-82BK</b>	<b>Universal Header Bracket Clear</b> <b>Universal Header Bracket Black</b> <b>Universal Header Bracket M82 Clear</b> <b>Universal Header Bracket M82 Black</b>
<b>HEADER EXTENSION BRACKET</b> 	<p>Header Extension Brackets are 90 degree angle brackets used to extend a narrow header to permit mounting of a Securitron Magnalock. Model HEB82 may be used with Securitron Magnalock versions M34 and M82.</p>	<b>HEB-3CL</b> <b>HEB-3BK</b> <b>HEB82-3CL</b> <b>HEB82-3BK</b>	<b>Header Ext. Bracket 3" Clear</b> <b>Header Ext. Bracket 3" Black</b> <b>Header Ext. Bracket M82 3" Clear</b> <b>Header Ext. Bracket M82 3" Black</b>
<b>DRESS COVERS</b> 	<p>Dress Covers are separately available for the Model 32, 34, 62 and 82 Magnalocks. They install in seconds using structural foam adhesive. The cover improves the appearance of the installation by concealing the lock. The covers are available in four finishes allowing easy alteration of the Magnalock finish to suit architectural considerations.</p>	<b>DC-32CL</b> <b>DC-32BK</b> <b>DC-32SP</b> <b>DC-32BP</b> <b>DC-34CL</b> <b>DC-34BK</b> <b>DC-34SP</b> <b>DC-34BP</b> <b>DC-62CL</b> <b>DC-62BK</b> <b>DC-62SP</b> <b>DC-62BP</b> <b>DC-82CL</b> <b>DC-82BK</b> <b>DC-82SP</b> <b>DC-82BP</b>	<b>Dress Cover M32 Clear</b> <b>Dress Cover M32 Black</b> <b>Dress Cover M32 Stainless Polished</b> <b>Dress Cover M32 Brass Polished</b> <b>Dress Cover M34 Clear</b> <b>Dress Cover M34 Black</b> <b>Dress Cover M34 Stainless Polished</b> <b>Dress Cover M34 Brass Polished</b> <b>Dress Cover M62 Clear</b> <b>Dress Cover M62 Black</b> <b>Dress Cover M62 Stainless Polished</b> <b>Dress Cover M62 Brass Polished</b> <b>Dress Cover M82 Clear</b> <b>Dress Cover M82 Black</b> <b>Dress Cover M82 Stainless Polished</b> <b>Dress Cover M82 Brass Polished</b>
<b>DOUBLE DRESS COVERS</b> 	<p>Double Dress Covers are available in two finishes, which will cover a pair of Magnalocks on a double door, assuming they are separated by not more than 2" [50mm].</p>	<b>DDC-32CL</b> <b>DDC-32BK</b> <b>DDC-62CL</b> <b>DDC-62BK</b> <b>DDC-82CL</b> <b>DDC-82BK</b>	<b>Double Dress Cover M32 Clear</b> <b>Double Dress Cover M32 Black</b> <b>Double Dress Cover M62 Clear</b> <b>Double Dress Cover M62 Black</b> <b>Double Dress Cover M82 Clear</b> <b>Double Dress Cover M82 Black</b>

# ELECTROMAGNETIC LOCKS

## MAGNALOCK SERIES HARDWARE

ITEM	APPLICATION USE	PART#	ORDERING DESCRIPTION
<p><b>Z BRACKETS</b></p> 	<p>Z Brackets are separately available for the "F" version 32, 34, 62 and 82 model Magnalocks and allow mounting on inswinging doors. The bracket includes a cover which gives the installation an attractive finished appearance.</p> <p>Z32: 8 5/8" x 5 1/16" x 2 3/4" [219mm x 129mm x 70mm]</p> <p>Z34: 10 1/2" x 5" x 2 3/8" [267mm x 127mm 60mm]</p> <p>Z62: 8 5/8" x 6 7/16" x 3" [219mm x 164mm x 72mm]</p> <p>Z82: 12 5/8" x 6 7/16" x 3" [321mm x 164mm x 72mm]</p>	<p>Z-32CL Z-32BK Z-32SS Z-34CL Z-34BK Z-34SS Z-62CL Z-62BK Z-62SS Z-82CL Z-82BK Z-82SS</p>	<p>Z-Bracket M32 Clear Z-Bracket M32 Black Z-Bracket M32 Stainless Steel Z-Bracket M34 Clear Z-Bracket M34 Black Z-Bracket M34 Stainless Steel Z-Bracket M62 Clear Z-Bracket M62 Black Z-Bracket M62 Stainless Steel Z-Bracket M82 Clear Z-Bracket M82 Black Z-Bracket M82 Stainless Steel</p>
<p><b>SNAP-COVER HEADER BRACKET</b></p> 	<p>The Snap-cover Header Bracket is used to extend a narrow header (often found on aluminum frame glass doors) to permit mounting of the Magnalock. The bracket extends the header, and serves to conceal the hookup cable within its hollow interior. The two-piece installation consists of the L-Bracket and a stainless steel dress cover.</p> <p>SHB-34SS: 9 7/8" x 2 7/16" x 1 7/8" [251mm x 62mm x 48mm]</p> <p>SHB-62SS: 8 1/8" x 2 3/8" x 2 1/2" [206mm x 60mm x 63mm]</p>	<p>SHB-34SS SHB-62SS</p>	<p>Snap-cover Header Bracket M34 Stainless Snap-cover Header Bracket M62 Stainless</p>
<p><b>UNIVERSAL MOUNTING BRACKET</b></p> 	<p>The UMB-34 Bracket replaces the ASB and CWB Brackets and permits M34 mounting on wood or concrete filled steel headers. The UMB-34 is reversible, altering the projection of the bracket at the top of the magnet body, permitting use with varied stop thicknesses. The bracket is delivered with a selection of fasteners for different applications.</p>	<p>UMB-34CL</p>	<p>Universal Mounting Bracket M34 Clear</p>
<p><b>MAGNALOCK INSTALLATION KIT</b></p> 	<p>The Official Factory Installation Kit makes any installation quicker and more accurate. It even includes an educational, step-by-step system installation video! Here is what is included:</p> <p>Heavy duty drill guide • Blind nut placement tool • Handle socket driver • SB-1 sex bolt • Model 62/82 hardware pack • Model 32 hardware pack • SAM hardware pack w/ brackets (on request) • Rubber washers • Flat washers • Insulated crimp connector • Thread lock • 1/8" Cobalt drill bit • 3/8" Cobalt drill bit • 3/8" Carbide drill bit • 1/2" High speed drill bit • Socket cap screws • Wood screws • Blind nuts • Lock nuts • Finish caps • Installation video</p>	<p>IK</p>	<p><b>Installation Kit</b></p> <p>Individual IK Parts*</p> <p><b>BPT-2</b> Blind Nut Tool <b>SDG-1</b> Drill Guide <b>COD-125</b> 1/8" Cobalt Drill Bit <b>COD-375</b> 3/8" Cobalt Drill Bit <b>CAD-375</b> 3/8" Carbide Drill Bit</p>

**MAGNALOCK APPROVALS and LISTINGS**

Underwriter's Laboratories: SA6635 & BP7041 & R13976  
 Underwriter's Laboratories of Canada: CMS140, SA6635, BP7041 & R13976  
 TUV (Germany): 9510632  
 California State Fire Marshall: 3774-0923:101, :102 & :103  
 City of New York MEA: 25195E & 254-95E BHMA certified  
 NYC Board of Standards and Appeals; 801-80-SA  
 City of Cleveland: S-5-89  
 US Veteran's Administration: M.P.3 Part III  
 US Defense Department: Listed

**PATENTS**

Sensstat feature and internal electronics, U.S. Patent #4,516,114 & #4,682,801  
 EASB, U.S. patent #5,758,913

Magnalock armature, mounting hardware and fastener assembly.

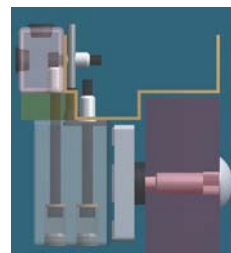
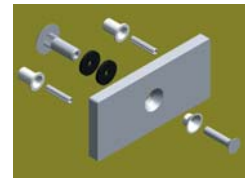

Model 62 or 82 on hollow metal frame assembly with Universal Header Bracket and Stop Filler Plate.